

Georgia Southern
University's
Armstrong
Campus
Arboretum
Savannah, GA

What's Growing?



Philip Schretter

- Graduate from UGA in 1987
- Began career as the Grounds Superintendent in 1993
- Officially established the campus as an Arboretum in 2001
- Mastermind behind the Arboretum's appearance and purpose
- Retired after a successful career in 2022





Welcome

- Welcome to the Georgia Southern University's Armstrong Campus Arboretum. The Arboretum encompasses Armstrong's 250 acre campus and displays over 150 species of trees and over 300 species of shrubs and other woody plants. Developed areas of campus contain native and introduced species of trees and shrubs, the majority of which are labeled. Natural areas of campus contain plants typical in Georgia's coastal broadleaf evergreen forests such as live oak, southern magnolia, red ray, horse sugar, and sparkleberry.

Purpose

- The function of the Arboretum can be divided into four areas; teaching, conservation, community outreach, and recreation.



Teaching

- The Arboretum provides an outdoor laboratory for use by faculty and students in Botany, Biology, Environmental Studies, Photography, Art, and other departments.



Conservation

- The Arboretum functions as a sanctuary for the preservation and conservation of plants. With collections of native and exotic flora, the Arboretum provides a model for environmentally sound urban landscape management.



Community Outreach

- The Arboretum allows the university to provide botanical and horticultural information to the community. Educational opportunities can be provided in the form of workshops, demonstrations, and tours. Maps, and plant guides allow the public to explore the Arboretum on their own.



Recreation

- The Arboretum provides a place where people of the University and the community may enjoy passive recreation in a beautiful setting. By walking through the collections or enjoying a stop on one of the many benches, visitors can renew themselves through contact with the natural world.



Collections

- Plant collections are an important component of any arboretum and contribute to establishing an arboretum's identity.



The Conifer Garden



CONIFER COLLECTION

- 1. *Pinus strobus* - Lacebark Pine
- 2. *Juniperus chinensis* 'Sea Green' - Sea Green Chinese Juniper
- 3. *Liquidambar glyptostroboides* - Dawn Redwood
- 4. *Cupressocyparis leylandii* 'Harlequin' - Harlequin Leyland Cypress
- 5. *Quercus laevis* - Golden Larch
- 6. *Cedrus deodara* - Deodar Cedar
- 7. *Chamaecyparis thyoides* 'Pendula' - Weeping Atlantic Whitecedar
- 8. *Juniperus horizontalis* 'Prince of Wales' - Prince of Wales Creeping Juniper
- 9. *Juniperus squamata* 'Blue Star' - Blue Star Juniper
- 10. *Chamaecyparis thyoides* 'Shiva' - Shiva Atlantic Whitecedar
- 11. *Chamaecyparis obtusa* 'Filicoides' - Fernspray Hinoki Falsecypress
- 12. *x Cupressocyparis leylandii* - Leyland Cypress
- 13. *Cryptomeria japonica* 'Taisho Tamasugi' - Taisho Tamasugi Japanese Cryptomeria
- 14. *Cupressus sempervirens* 'Swane's Golden' - Swane's Golden Italian Cypress
- 15. *Chamaecyparis pisifera* 'Gold Mop' - Goldmop Threadleaf Cypress
- 16. *Cryptomeria japonica* 'Globosa Nana' - Japanese Cryptomeria
- 17. *Thuja occidentalis* 'Golden Globe' - Golden Globe Eastern Arborvitae
- 18. 0
- 19. *Juniperus chinensis* 'Hetzi Variegata' - Variegated Hetzi Chinese Juniper
- 20. *Cupressus arizonica* 'Silver Smoke' - Silver Smoke Arizona Cypress
- 21. *Juniperus davurica* 'Expansa' ('Parsoni') - Parson's Juniper
- 22. *Platycladus orientalis* 'Aurea Nana' - Berckman's Golden Arborvitae
- 23. *Juniperus chinensis* 'Kaizuka' - Hollywood Juniper
- 24. 0
- 25. 0
- 26. *Thujaopsis dolobrata* 'Nana' - Dwarf Thujaopsis
- 27. 0
- 28. 0
- 29. *Cupressus sempervirens* - Italian Cypress
- 30. *Juniperus chinensis* 'Old Gold' - Old Gold Chinese Juniper
- 31. *Juniperus chinensis* 'Gold Point' - Blue Point Chinese Juniper
- 32. *Juniperus chinensis* 'Blue Point' - Blue Point Chinese Juniper
- 33. *x Cupressocyparis leylandii* 'Gold Cup' - Gold Cup Leyland Cypress
- 34. *Cryptomeria japonica* 'Sekkan Sugi' - Sekkan Sugi Japanese Cedar
- 35. *Thuja occidentalis* 'Smaragd' - Emerald Green Arborvitae
- 36. *Juniperus davurica* 'Expansa Variegata' ('Parsoni') - Variegated Parson's Juniper
- 37. *Juniperus chinensis* 'Sargentii' - Sargeant's Juniper
- 38. *Thuja occidentalis* 'Degroot's Spire' - Degroot's Spire Eastern Arborvitae
- 39. *Juniperus conferta* 'Blue Pacific' - Blue Pacific Shore Juniper
- 40. *Chamaecyparis pisifera* 'Sungold' - Sungold Japanese Falsecypress
- 41. *Thuja occidentalis* 'Woodwardii' - Globe Eastern Arborvitae
- 42. *Juniperus procumbens* 'Nana' - Dwarf Japanese Garden Juniper
- 43. *Chamaecyparis obtusa* 'Tempelhof' - Tempelhof Hinoki Falsecypress
- 44. 0
- 45. *Thuja occidentalis* 'Holstun' - Holstun Eastern Arborvitae

- 55. *Chamaecyparis thyoides* 'Red Star' - Red Star Atlantic Whitecedar
- 56. *Cupressus arizonica* 'Blue Pyramid' - Blue Pyramid Arizona Cypress
- 57. *Cunninghamia lanceolata* 'Chason's Gift' - Chinafir
- 58. *Abies firma* - Japanese Fir
- 59. *Juniperus virginiana* 'Canaertii' - Canaertii Eastern Redcedar
- 60. *Juniperus chinensis* 'Blue Vase' - Blue Vase Chinese Juniper
- 61. *Juniperus recurva*
- 62. *Pinus thunbergii* - Black Japanese Pine
- 63. *Juniperus horizontalis* 'Wiltonii' - Blue Rug Creeping Juniper
- 64. *x Cupressocyparis ovensii*
- 65. *Thuja plicata* 'Green Splendor' - Green Splendor Giant Arborvitae
- 66. *Chamaecyparis pisifera* 'Squarrosa Lutea' - Squarrosa Falsecypress
- 67. *Cephalotaxus sinensis*
- 68. *Podocarpus henkelii* - Yew-pine
- 69. 0
- 70. *Chamaecyparis obtusa* 'Snowkist' - Snowkist Hinoki Cypress
- 71. *Cryptomeria japonica* 'Spiraliter Falcata' - Spiral Japanese Cryptomeria
- 72. *Cedrus deodara* 'Crystal Falls' - Crystal Falls Deodar Cedar
- 73. *Athrotaxis laxifolia* - Tasmanian Pencil Pine
- 74. *Tetracium articulata*
- 75. *Podocarpus lawrencei* - Mountain Plum Pine
- 76. 0
- 77. *Cryptomeria japonica* 'Vilmoriniana' - Vilmoriniana Japanese Cryptomeria
- 78. *Chamaecyparis pisifera* 'Silverload' - Silverload Japanese Falsecypress
- 79. *Cephalotaxus harringtonia* 'Fastigiata' - Japanese Plum Yew
- 80. *Cephalotaxus harringtonia* var. *drupacea* - Japanese Plum Yew
- 81. *Chamaecyparis obtusa* 'Nana Lutea' - Dwarf Hinoki Cypress
- 82. *Chamaecyparis obtusa* 'Nana Gracilis' - Dwarf Hinoki Cypress
- 83. *Cryptomeria japonica* 'Osaka-tama' - Dwarf Japanese Cedar
- 84. *Juniperus silicicola* - Southern Red Cedar
- 85. *Araucaria bidwillii* - Bunya Bunya Tree
- 86. *Widdingtonia nodiflora*
- 87. *Cupressus duclouxiana*
- 88. *Juniperus chinensis* 'Spartan'
- 89. *x Cupressocyparis leylandii* 'Golonconda'
- 90. *Cephalotaxus harringtonia* 'Korean Gold'
- 91. *Cryptomeria japonica* 'Dacrydiodes'
- 92. *Chamaecyparis funebris*
- 93. *Cupressus chengiana* var. *kansuensis*
- 94. *Chamaecyparis thyoides* 'Glauca Pendula'
- 95. *Taxus floridana*
- 96. *Chamaecyparis pisifera* 'Snow'
- 97. *Taxus globosa*
- 98. *Taxus* ?
- 99. *Cryptomeria japonica* 'Cristata'
- 100. *Cunninghamia konishii* 'Little Leo'
- 101. *Cephalotaxus harringtonia* 'Prostrata'

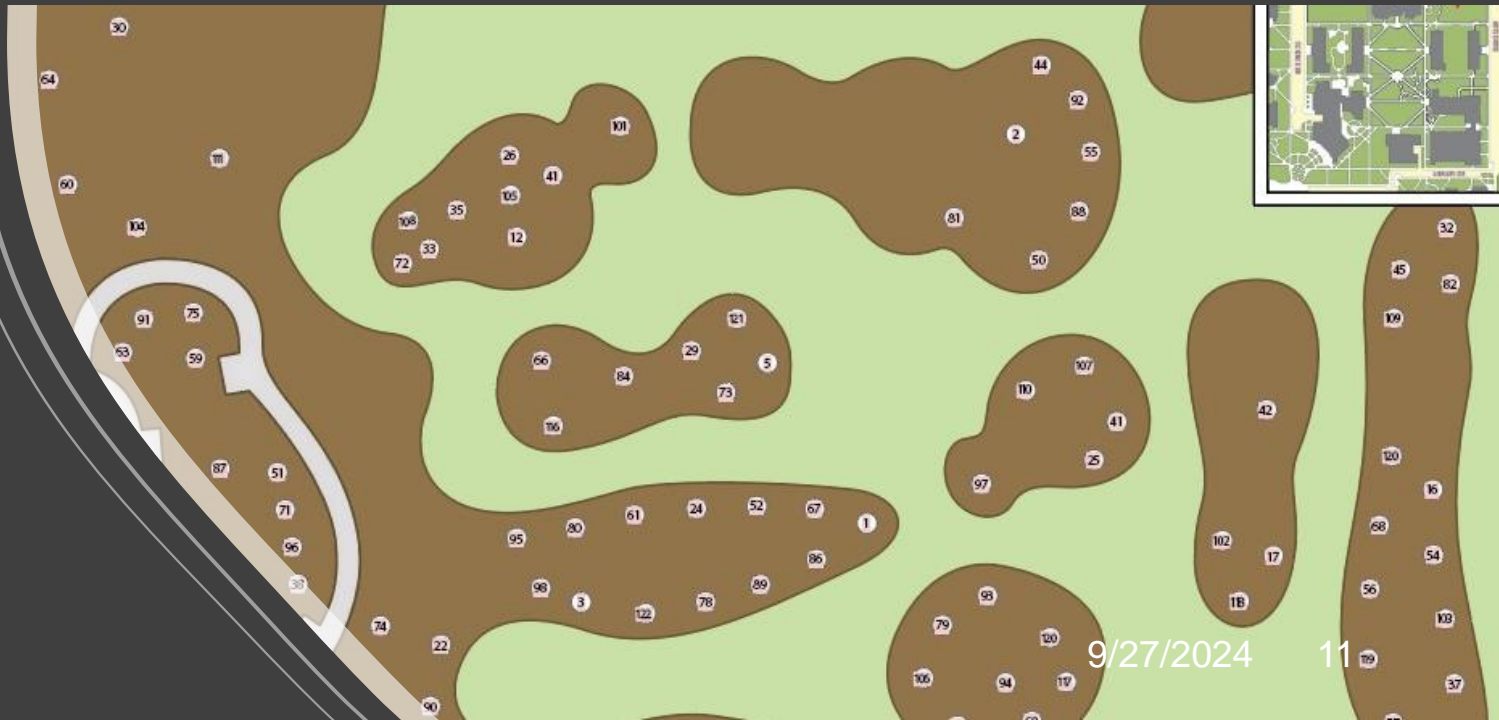







9/27/2024

14

The Ginger Collection



The Ginger Garden

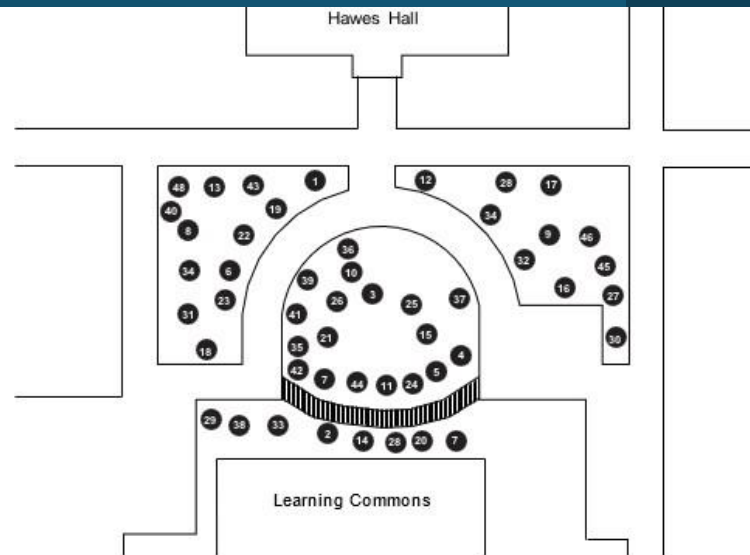

1. *Alpinia galanga*- Thai Spice Ginger
2. *Alpinia zerumbet*- Shell Ginger
3. *Alpinia zerumbet* 'Variegata'- Shell Ginger
4. *Comukaempferia aurantifolia* 'Jungle Gold'- Peacock Ginger
5. *Costus barbatus*- Red Tower Ginger
6. *Costus curvibractaeus*- Orange Tulip
7. *Costus pictus*- Spiral Ginger
8. *Costus speciosus* 'Variegatus'- Crepe Ginger
9. *Costus varzeanum*- Red Spiral Ginger
10. *Curcuma alismatifolia* 'Kimono Pink'- Siam Tulip
11. *Curcuma aurantiaca*- Rainbow Curcuma
12. *Curcuma australasica*- Aussie Plume
13. *Curcuma longa*- Turmeric
14. *Curcuma ornata*- Ornate Plume Ginger
15. *Curcuma petiolata* 'Emperor'- Hidden Ginger
16. *Curcuma roscoeana* 'Alimanda'- Orange Hidden Ginger
17. *Curcuma zedoaria*- Zedoary
18. *Curcuma* 'Laddawan'- Hidden Ginger
19. *Curcuma* 'Scarlet Fever'- Hidden Ginger
20. *Curcuma* 'Raspberry'- Hidden Ginger
21. *Elestaria cardamomum*- Green Cardamom
22. *Globba schomburgkii*- Yellow Dancing Ladies
23. *Globba winitii*- Mauve Dancing Ladies
24. *Globba winitii* 'Blushing Maiden'- Mauve Dancing Ladies
25. *Hedyohium oococcineum* 'Disney'- Orange Bottlebrush Ginger
26. *Hedyohium coronarium*- Butterfly Ginger
27. *Hedyohium flavescens*- Yellow Ginger
28. *Hedyohium gardnerianum*- Kahili Ginger
29. *Hedyohium greeni*- Red Leaf Ginger
30. *Hedyohium x kewensis*- Hardy Ginger Lily
31. *Hedyohium* 'Dr. Moy'- Hardy Ginger Lily
32. *Hedyohium* 'Elizabeth'- Hardy Ginger Lily
33. *Hedyohium* 'Pink V'- Hardy Ginger Lily
34. *Kaempferia laotica* 'Satin Cheeks'- Peacock Ginger
35. *Kaempferia pulchra* 'Bronze Peacock'- Peacock Ginger
36. *Kaempferia pulchra* 'Mansonii'- Peacock Ginger
37. *Kaempferia pulchra* 'Silver Spot'- Peacock Ginger
38. *Kaempferia rotunda* 'Grande'- Resurrection Lily
39. *Kaempferia rotunda* 'Raven'- Resurrection Lily
40. *Kaempferia* 'Alva'- Resurrection Lily
41. *Siphonochilus deoora*- Yellow African Trumpet Ginger
42. *Siphonochilus kirkii*- Pink African Trumpet Ginger
43. *Zingiber niveum* 'Milky Way'- Milky Way Ginger
44. *Zingiber spectabile*- Beehive Ginger
45. *Zingiber* *vinosum*
46. *Zingiber zerumbet*- Shampoo Ginger





The Fern Garden



The Fern Garden

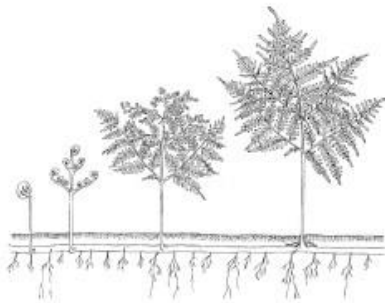
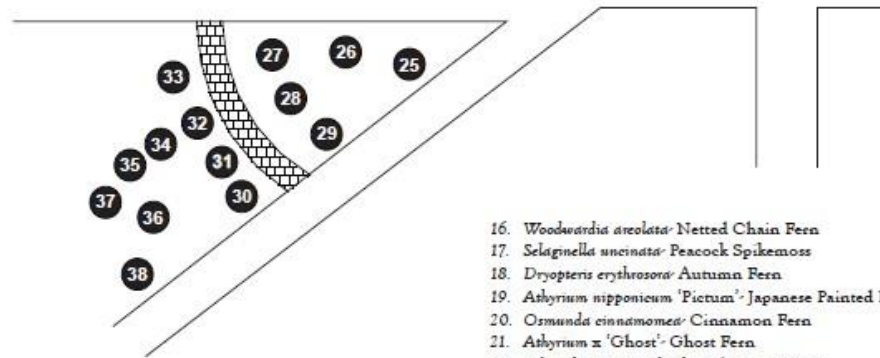
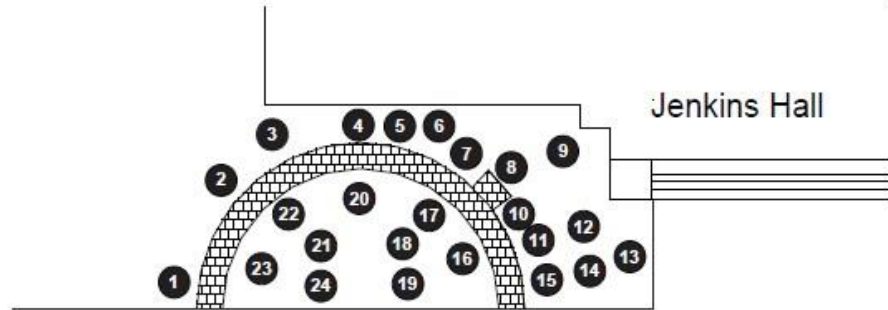

1. *Dryopteris celsa* Log Fern
2. *Osmunda regalis* Royal Fern
3. *Thelypteris kunthii* Southern Shield Fern
4. *Cyrtosium falcatum* Holly Fern
5. *Dicksonia antarctica* Tasmanian Tree Fern
6. *Adiantum pedatum* Noethern Maidenhair Fern
7. *Selaginella moellendorffii* Gemmiferous Spikemoss
8. *Dryopteris x australis* Dixie Wood Fern
9. *Cyathea cooperii* Australian Tree Fern
10. *Adiantum hispidulum* Rosy Maidenhair Fern
11. *Pteris vittata* Ladder Brake
12. *Thelypteris beddomei* Korean Maiden Fern
13. *Nephrolepis obliterata* Australian Sword Fern
14. *Thelypteris dentata* Downy Maiden Fern
15. *Lepisorus bicolor* Sichuan Ribbon Fern
16. *Woodwardia areolata* Netted Chain Fern
17. *Selaginella uncinata* Peacock Spikemoss
18. *Dryopteris erythrosora* Autumn Fern
19. *Athyrium nipponicum* 'Pictum' Japanese Painted Fern
20. *Osmunda cinnamomea* Cinnamon Fern
21. *Athyrium* x 'Ghost' Ghost Fern
22. *Polystichum acrostichoides* Christmas Fern
23. *Polystichum tsu-simense* Korean Rock Fern
24. *Asplenium nidus* Bird's Nest Fern
25. *Nephrolepis biserrata* Macho Fern
26. *Didymochlaena trunculata* Mahogany Fern
27. *Pyrosia lingua* Tongue Fern
28. *Polystichum polyblepharum* Tassel Fern
29. *Rumohra adiantiformis* Leatherleaf Fern
30. *Dryopteris cycadina* Shaggy Shield Fern
31. *Woodwardia orientalis* Oriental Chain Fern
32. *Asplenium scolopendrium* Hart's Tongue Fern
33. *Antichnoides simplicior* 'Variegata' East India Holly Fern
34. *Diplazium pycnocarpon* Glade Fern
35. *Microlepia strigosa* Lace Fern
36. *Cyrtosium fortunei* Fortune's Holly Fern
37. *Dryopteris goldiana* Goldie's Wood Fern
38. *Pyrosia lingua* 'Variegata' Variegated Tongue Fern





Camellia Collection



The Camellia Garden

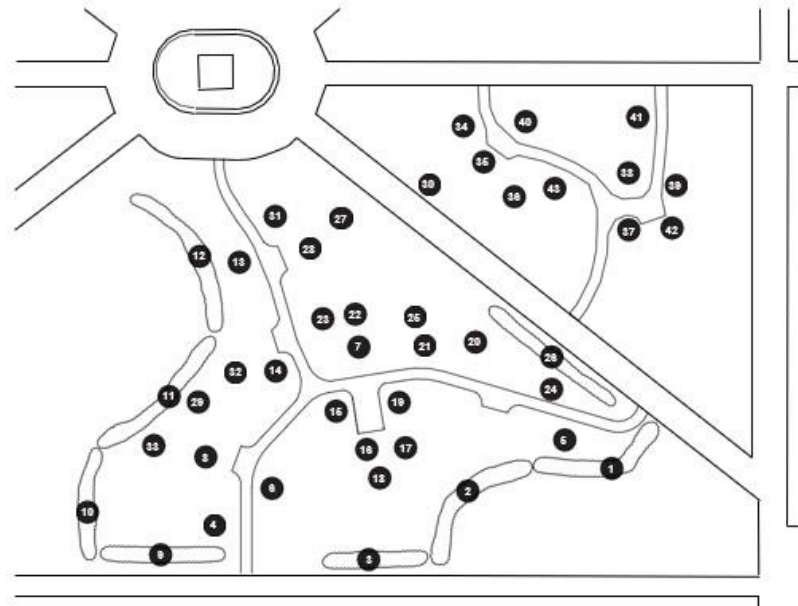

- | | |
|--|--|
| 1. <i>Camellia sasanqua</i> 'Narumigata' | 23. <i>Camellia pilophylla</i> |
| 2. <i>Camellia sasanqua</i> 'Yuletide' | 24. <i>Camellia saluensis</i> |
| 3. <i>Camellia sasanqua</i> 'Bert Jones' | 25. <i>Camellia japonica</i> 'Jury's Yellow' |
| 4. <i>Camellia sinensis</i> var. <i>sinensis</i> | 26. <i>Camellia sasanqua</i> 'Shi Shi Gashira' |
| 5. <i>Camellia sinensis</i> var. <i>assamica</i> | 27. <i>Camellia japonica</i> 'Blue Danube' |
| 6. <i>Camellia octapetala</i> | 28. <i>Camellia longicarpa</i> |
| 7. <i>Camellia chekiangoleosa</i> | 29. <i>Camellia eurypoides</i> |
| 8. <i>Camellia albogigas</i> | 30. <i>Camellia sinensis</i> |
| 9. <i>Camellia sasanqua</i> 'Alabama Beauty' | 31. <i>Camellia yuhshienensis</i> |
| 10. <i>Camellia sasanqua</i> 'Northern Lights' | 32. <i>Camellia transnokoensis</i> |
| 11. <i>Camellia sasanqua</i> 'Kanjiro' | 33. <i>Camellia cordifolia</i> |
| 12. <i>Camellia sasanqua</i> 'Stephanie Golden' | 34. <i>Camellia roseaflora</i> 'Cascade' |
| 13. <i>Camellia oleifera</i> | 35. <i>Camellia lutchensis</i> |
| 14. <i>Camellia edithae</i> 'Dongnan Shancha' | 36. <i>Camellia reticulata</i> |
| 15. <i>Camellia japonica</i> 'Unryu-tsubaki' | 37. <i>Camellia stuyvantis</i> |
| 16. <i>Camellia brevistyla</i> | 38. <i>Camellia fraterna</i> |
| 17. <i>Camellia japonica</i> 'Crimson Candles' | 39. <i>Camellia</i> 'Transtasman' |
| 18. <i>Camellia x williamsii</i> 'Lavender Prince II' | 40. <i>Camellia grijsii</i> |
| 19. <i>Camellia japonica</i> var. <i>quercifolia</i> 'White Mermaid' | 41. <i>Camellia trichoclada</i> |
| 20. <i>Camellia orapnelliana</i> | 42. <i>Camellia fufunacea</i> |
| 21. <i>Camellia cuspidata</i> | 43. <i>Camellia oostei</i> |
| 22. <i>Camellia vietnamensis</i> | |



**Crapnell's
Camellia
*Camellia
crapnelliana***



Crapnell's Camellia

Camellia crapnelliana

- Evergreen
- 20-30' tall
- Part Shade
- Flowers in October



Crapnell's Camellia *Camellia crapnelliana*

- Native to Hong Kong and China
- Member of the Theaceae family
- One of approximately 100-250 species of evergreen shrubs and small trees native to eastern Asia



The International Garden



Plants from Around the World

Similar
Growing
Conditions

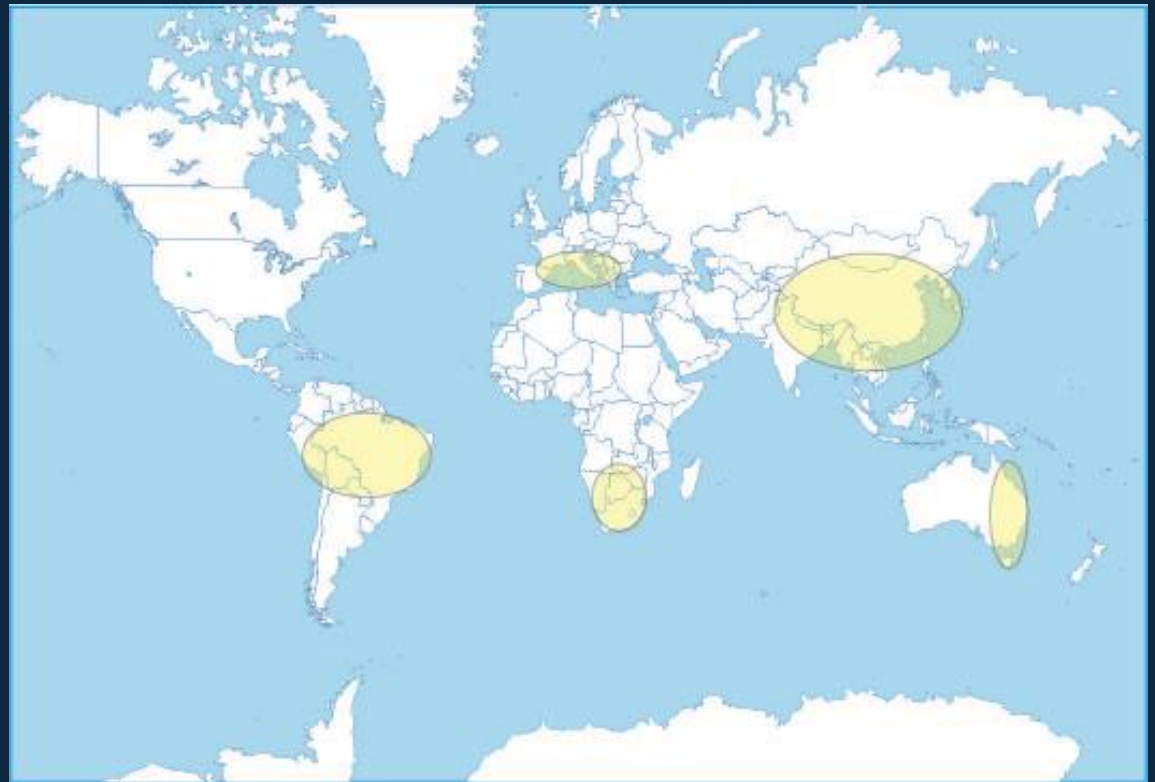

Overhead view of South America, Australia, and Europe



Asia



Primitive Garden



Primitive Garden

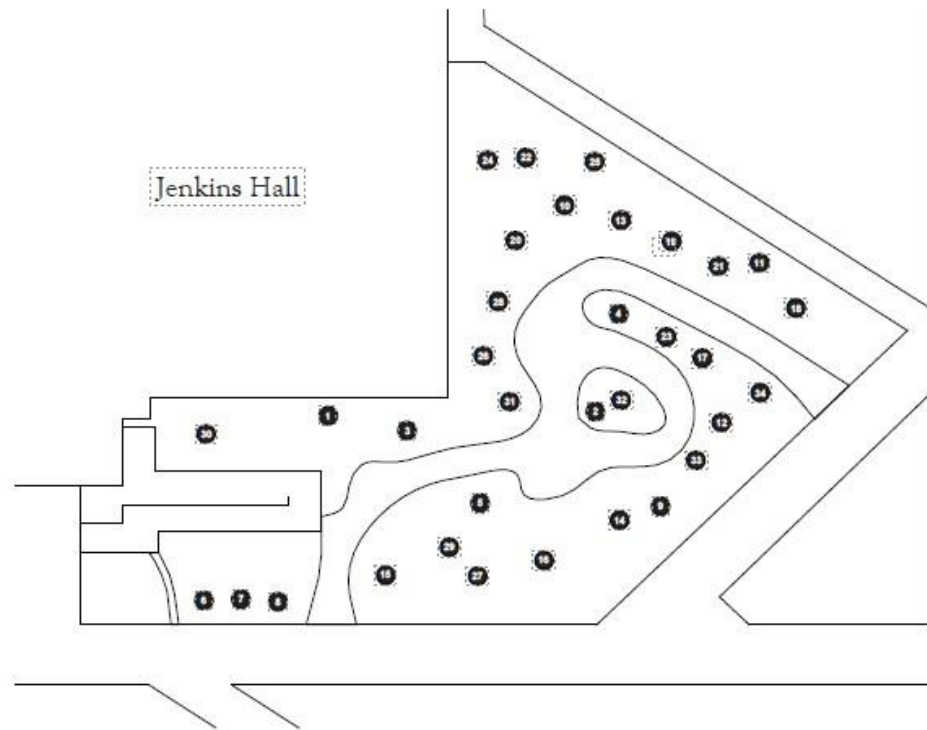

1. *Cyathea cooperi*- Australian Tree Fern
2. *Marsilea macropoda*- Clover Fern
3. *Osmunda cinnamomea*- Cinnamon Fern
4. *Osmunda regalis*- Royal Fern
5. *Thelypteris kunthii*- Southern Shield Fern
6. *Equisetum hyemale*- Rough Horsetail
7. *Equisetum scirpoides*- Dwarf Horsetail
8. *Equisetum diffusum*- Himalayan Horsetail
9. *Cycas revoluta*- Sago Palm
10. *Cycas taiwaniana*
11. *Dioon edule*- Virgin Palm
12. *Zamia pumila*- Coontie
13. *Ginkgo biloba*- Ginkgo
14. *Araucaria araucana*- Monkey Puzzle Tree
15. *Cephalotaxus fortunei*- Chinese Plum Yew
16. *Cephalotaxus sinensis*- Chinese Plum Yew
17. *Cryptomeria japonica* 'Araucarioides'

18. *Cunninghamia lanceolata*- Chinafir
19. *Cupressus chengiana* var. *kansuensis*
20. *Keteleeria davidiana*
21. *Keteleeria evelyniana*
22. *Metasequoia glyptostroboides*- Dawn Redwood
23. *Podocarpus henkelii*
24. *Podocarpus macrophyllus*- Chinese Podocarpus
25. *Podocarpus totara*- Totara
26. *Pinus patula*- Mexican Weeping Pine
27. *Cycas taitungensis* - Prince Sago
28. *Taiwania cryptomerioides* - Coffin Tree
29. *Taxodium distichum* - Baldcypress
30. *Taxodium ascendens*- Pondcypress
31. *Tetraclinus articulata*- Thyine Wood
32. *Torreya grandis*- Chinese Nutmeg Tree
33. *Widdringtonia nodiflora*
34. *Magnolia grandiflora* 'Little Gem'- Southern Magnolia

Chinese Nutmeg Tree

Torreya grandis

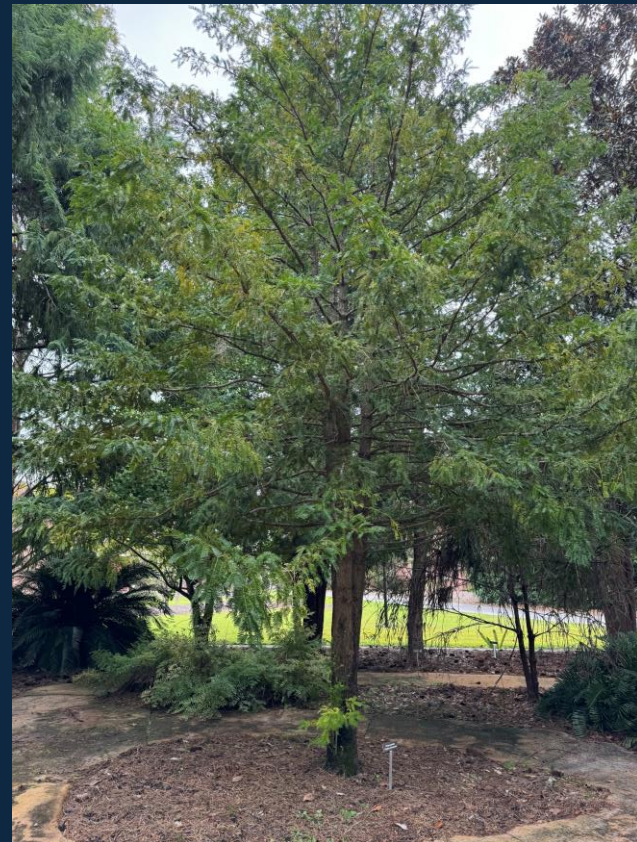

China Fir

Cunninghamia lanceolata

9/27/2024

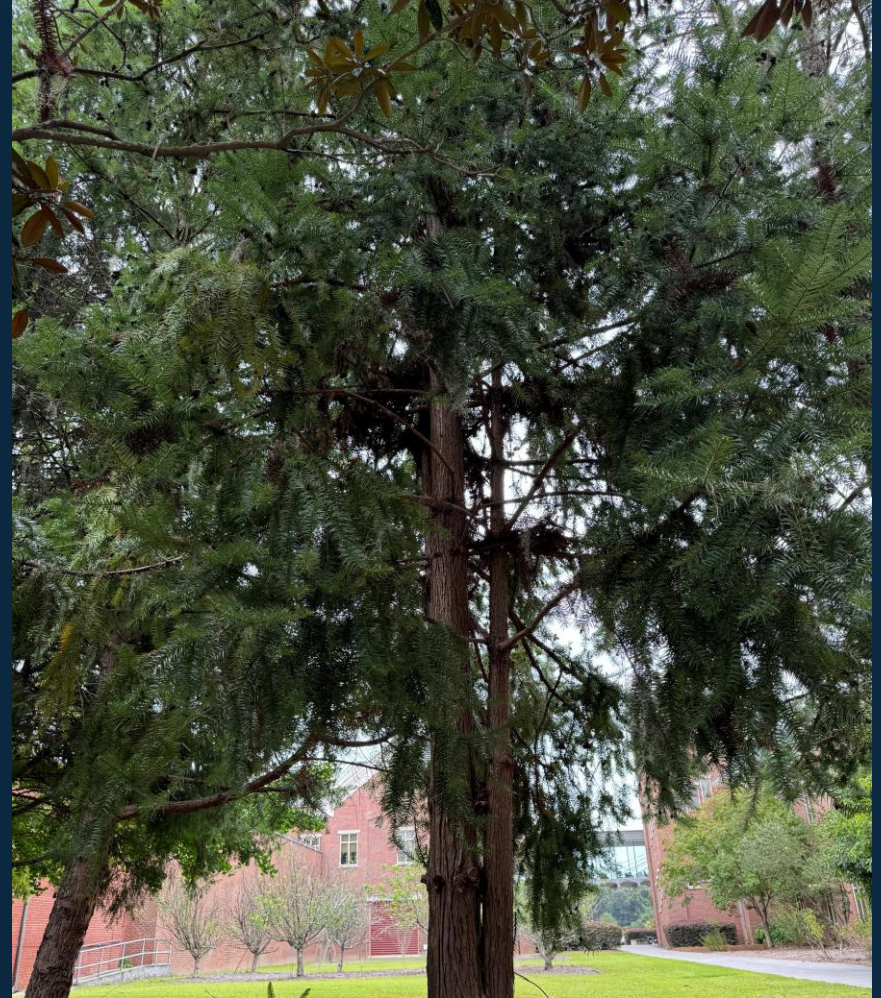

Plant tags

Auracaria bidwillii
bunya-bunya

Process

- Each stake is cut to 15" from 8' aluminum sticks
- Once cut to length, we then cut the stake to a point to penetrate the ground
- We then bend the other end of the stake at an angle so the plant label can be easily read
- Once the stake is complete, we adhere a plant tag with double sided tape



Laser Engraver

We are currently using a
Laser Solution LS100
“Gravograph”



Mapping

The Arboretum now has an interactive GIS map which identifies plants by name, family, and native range.

Map Data Base

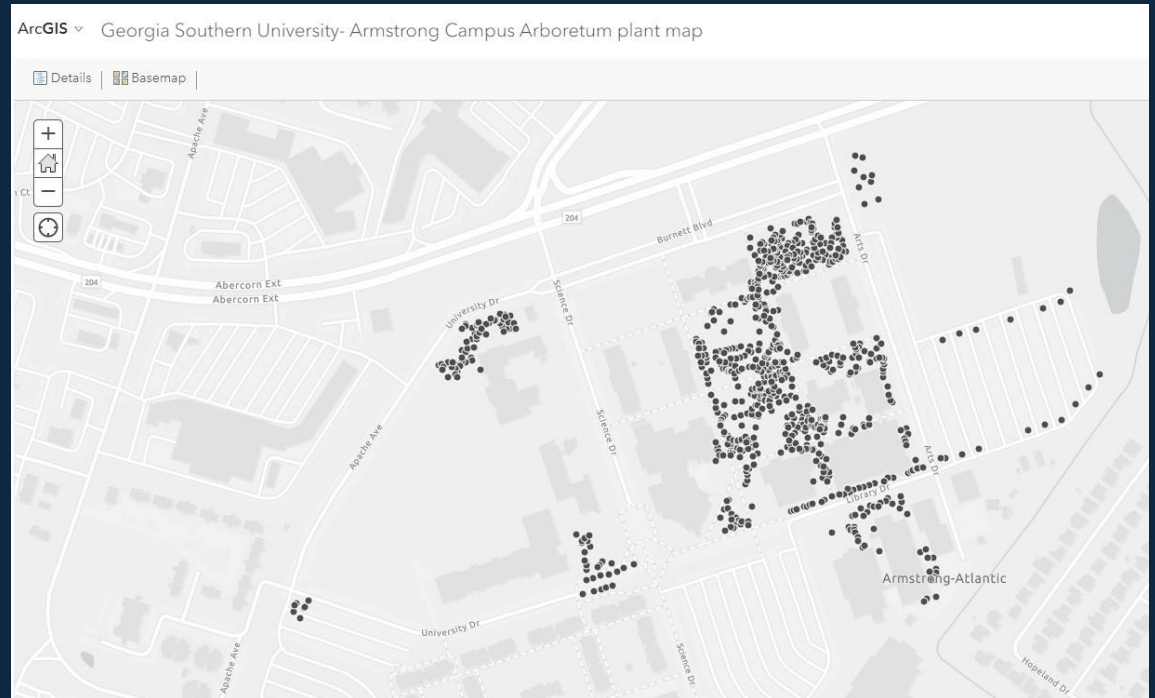



Conifer Garden Map

**Sciadopitys
verticillate
'Wintergreen'
Common:
Umbrella Pine**

usa 'Tetragona Aurea'

Sciadopitys verticillata 'Wintergreen'

- Chamaecyparis obtusa 'Nana Gracili
- Cryptomeria japonica 'Osaka Tama'

Sciadopitys verticillate 'Wintergreen' Common: Umbrella Pine

map

Share Print Measure

ona Aurea'

Sciadopitys verticillata
'Wintergreen'
common name umbrella pine
family Sciadopityaceae
native range garden origin

[Zoom to](#)

Chamaecyparis obtusa 'Nana Gracilis'

Cryptomeria japonica 'Osaka Tama'

Platycladus

**Sciadopitys
verticillate
'Wintergreen'
Common:
Umbrella Pine**



Abies firma

torulosa var. gigantea

Metasequoia glyptostroboides 'White Spot'

Podocarpus macrophyllus 'Royal Flush'

**Metasequoia
glyptostroboides
'White Spot'
Common: Dawn
Redwood**

Abies firma

botanical name	Metasequoia glyptostroboides 'White Spot'
common name	dawn redwood
family	Cupressaceae
native range	garden origin
Zoom to	

Metaseq

us torulosa var. gigantea

Podocarpus macrophyllus 'Royal Flush'

**Metasequoia
glyptostroboides
'White Spot'
Common: Dawn
Redwood**

**Metasequoia
glyptostoboides
'White Spot'
Common: Dawn
Redwood**



Honorable Mentions

Tung-oil Tree

Vernici fordii

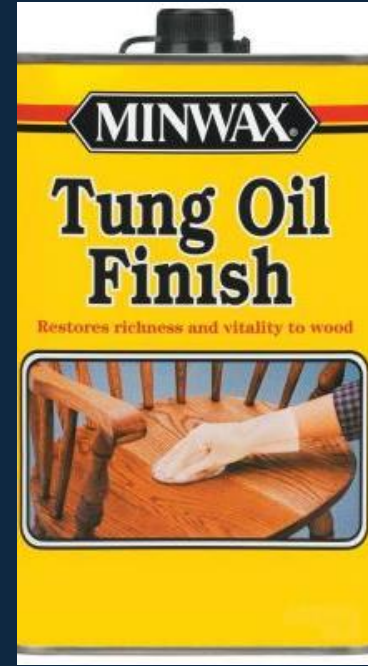

**Two-winged
Silverbell**
Halesia diptera

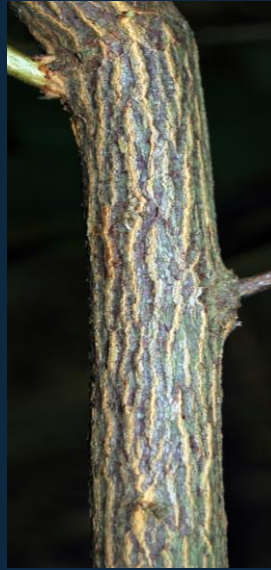

**Japanese
Flowering
Apricot**
Prunus mume



**Chinese
Evergreen
Dogwood
*Cornus
elliptica***



**Red
Buckeye**
*Aesculus
pavia*



Bunya pine *Araucaria bidwillii*

~ 9 pounds!



Longleaf vs Bunya



**Not recommended
to plant near
pedestrian
walkways!!!**



**Thanks for
listening!**

